



iGET
HOME  [®]
GUARD

BabyCare

Quick Start Guide - EN



Model: HGWIP-819

HGWIP-819



5 060442 178199

iGET HOMEGUARD 2020

✉ www.iget.eu/cs/helpdesk-centrum-cs

🌐 <https://helpdesk.intelek.cz>



Made in China



GIVES YOU
PEACE OF MIND
WHEREVER YOU ARE

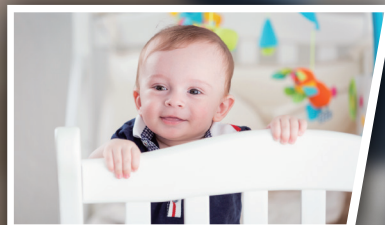

BABY

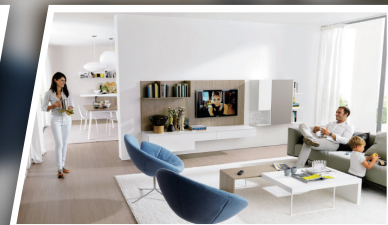

FAMILY



Welcome

What's included



Camera



Power Adapter



Quick Start Guide



User Manual



Bracket



Warning Sticker



Fixings



Wall Plug

Parts & Description



Front

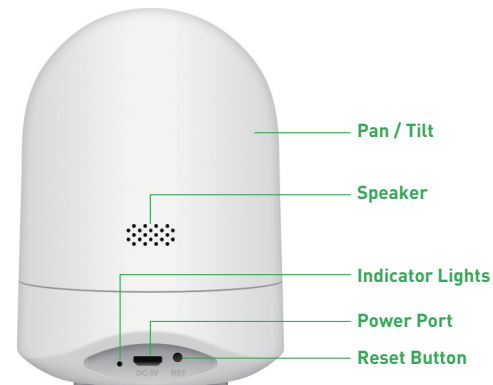

Rear

Step 1 Power on Camera

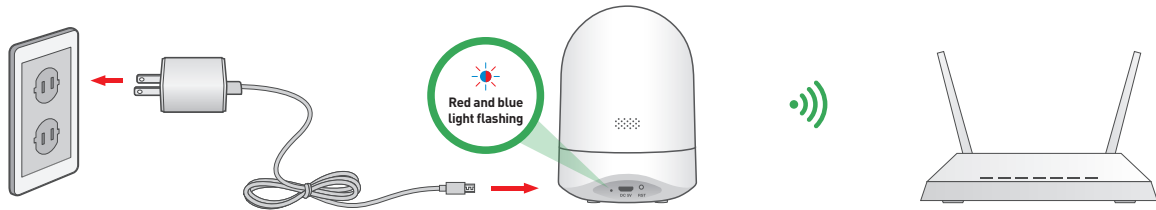

1 Connect the AC adapter to your camera and plug it in.

2 If you see the blue and red lights flashing, camera waiting to connect.

Indicator Lights Status

Indicator Light Status	Camera Status
● Red light on	Camera is powered on
⚡ Red and blue light alternately flashing	Waiting to connect now
⚡ Blue light flashing	Camera is connecting Wi-Fi
● Blue light solid	Succeeded to connect Wi-Fi
⚡ Red light quickly flashing	1. Reset camera to factory setting 2. Camera is upgrading firmware



3 Make sure you are within range of the same Wi-Fi network you'll use for your camera.

Step 2 Get the App

For the best experience, download the Homeguardone app for your smartphone by scanning the QR code below or searching for "Homeguardone" in the app store.

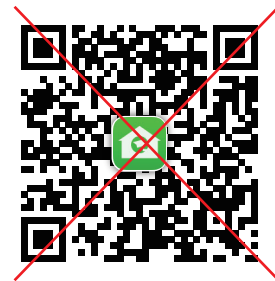

Step 3 Account Register

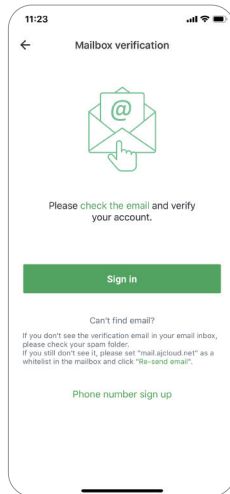
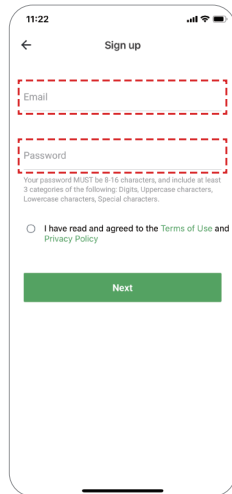
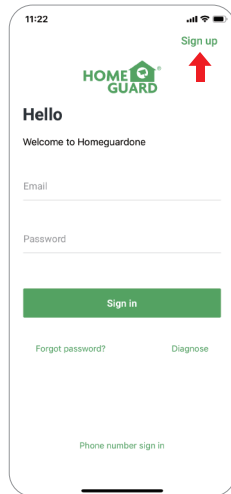

- 1 Open Homeguardone App, then select Sign up.
- 2 Enter your email. Create a password at least 8 characters long. Your password must include three of the following:
 - *At least one uppercase letter*
 - *At least one lowercase letter*
 - *At least one number*
- 3 You will receive an email with your Activation Link. Open the link to activate your account. Go back to login your account after activation successful.

Step 4 Add device

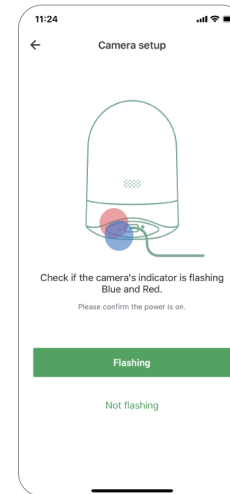
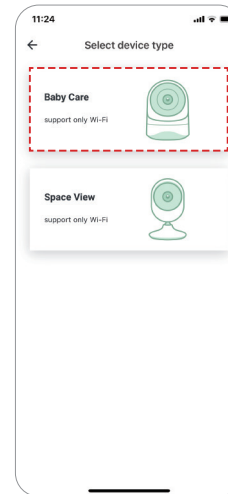
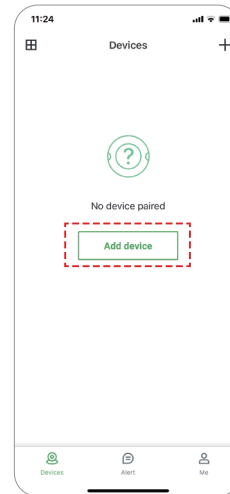

- 1 Login your account and tap “Add device”.
 - 2 Choose the “Baby Care” to connect.
 - 3 Check if the camera’s indicator is flashing Blue and Red. If not, Please try to reset the camera.
- Reset Method:** Keep the camera powered on for more than 1 minute, then press and hold “Reset” button until the LED turns red.



Step 5 Connect to Network

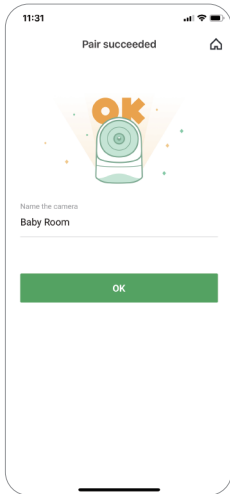
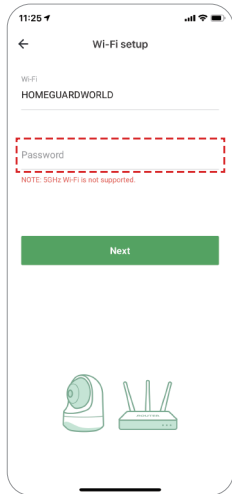

- 1 Enter the correct Wi-Fi password.
Note: *The camera is not support 5GHz Wi-Fi.*
- 2 This App will generate a QR code, place the QR code 3~8 inches in front of the camera lens. when the camera prompt **“QR code scanning is successful”**, press **“Next”** and wait a moment.
- 3 Name the camera after the Pairing is successful. Press **“OK”** to complete the add operation.

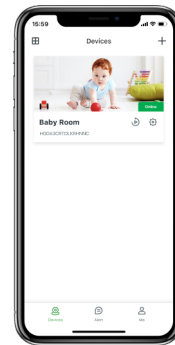

You're Done!

Congratulations! Your HGWIP819 BabyCare is set up and ready to go.

You are now free to position your camera anywhere in your home where you get a WiFi signal and view it remotely from anywhere in the world on your Smartphone or Tablet!

Home Page

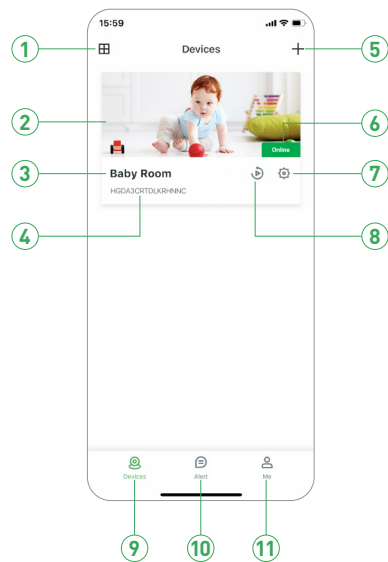

1	Split-screen	Tap to access Split-screen view
2	Live Video	Tap to start live view
3	Device name	Displays the camera name
4	Device ID	Displays the device cloud ID
5	Add Device	Tap to add a new camera
6	Device Status	Displays the camera network status
7	Setting	Tap to access camera setting
8	Replay	Tap to play the recorded video in the memory card
9	Devices	Tap to access device list page
10	Alerts	Tap to access alert information page
11	Me	Tap to access account information page

Live View

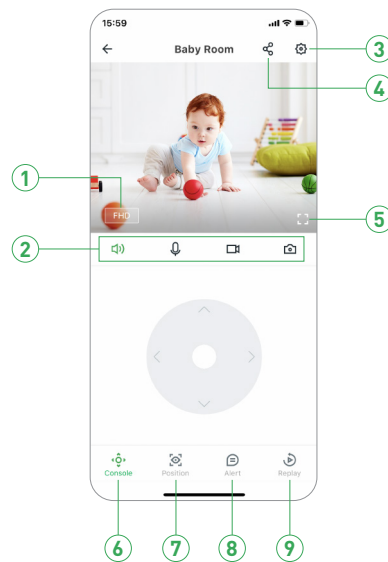

1	Resolution	Tap to change between video quality levels: SD, FHD
2	Mute / Unmute	Tap to hear the camera or unmute
	2-way talk	Activate the microphone to enable 2-way talk
	Record	Saves video clip from a live video
	Capture	Saves images captured from a live video
3	Setting	Tap to access camera setting
4	Share	Tap to share the camera to others
5	Full screen	Click to view in full screen
6	Console	Tap to enable pan & tilt controls
7	Position	Adds/Adjusts the preset and sets the home position
8	Alert	Tap to access alert list
9	Replay	Tap to play the recorded video in the memory card

View from Mac or Windows PC

Install Homeguardone software for your Mac or Windows PC from the included CD.



Specifications

Item	Description
Camera	1080p Full HD Video Recording, 110° Wide Angle Lens
Resolution	1920 × 1080, 640 × 360
Video	H.264, 1920 × 1080@15fps
Audio	Built-in Microphone & Speaker
Image Sensor	1/2.7" CMOS Sensor, f=3.6mm, F=2.2
Night Vision	4pcs SMT 940nm Lights, Up to 26ft/8m
Motion Detection	Supported, Will Activate Camera
Storage	Built-in 8GB Storage, Support up to 128GB
Pan / Tilt Range	Horizontal 350°, Vertical 90°
Power Input	DC 5V/1A, <5W
Wireless Speed	IEEE802.11b/g/n 150Mbps
Security Protocols	64/128-bit WEP, WPA/WPA2, WPA-PSK/WPA2-PSK
Dimensions / Weight	81mm × 81mm × 110mm, 199g